

SUBURBAN BANK BUILDING
5214 Baltimore Avenue
Hyattsville, Maryland

BOUNDARY:

Coterminous with the structure at Baltimore Avenue and Hamilton Street, as shown on attached photogrammetry.

DESCRIPTION:

The building is made up of two parts: the three (3) bay wide two story Neo-Classical Revival limestone building at the corner of Baltimore Avenue and Hamilton Street, which was constructed in the early 1920's as the Prince George's Bank, and the one-story Moderne Style addition on the south which was constructed two (2) or three (3) decades later.

The Neo-Classical Revival part is strikingly similar to, although simpler, than its major early 20th century competitor at the opposite end of the block, The First National Bank (now the Professional Building) which Suburban Bank absorbed briefly after the Bankers Holiday. It features a dignified entrance facade on Baltimore Avenue with unfluted columns topped by Ionic capitals, arranged distyle in antis between pilaster responds on each side. The columns carry a simple entablature, topped by a parapet.

The north side is six (6) bays wide, with the two (2) on the west set back from the forward plane of the others. The four (4) remaining bays are regularly fenestrated with windows paired between attached pilasters. The windows are divided vertically into three (3) parts, with a fretwork pattern on the sills. The treatment is extremely austere and seems to anticipate the stripped classicism which characterizes numerous institutional designs of the late 1920's and 1930's.

The one story Moderne Style addition on the south corresponds well with the academic approach to the Neo-Classical Revival seen on the north side. The facade is flat except for the coping at the roofline, the projected flat roof over the entry, and the windows which are slightly recessed. Although the entry area is centered between two (2) small windows punched into the walls on either side, the initial perception of symmetry is undermined by numerous elements which are not centered, among them a vitrolite vertical panel on the far south side of the facade and the placement of the doorway in the south part of the six (6) part entryway (to the left of the five (5) vertical windows). A set of vitrolite panels is arranged vertically to the left of the door and another placed horizontally under the windows.

STATEMENT OF SIGNIFICANCE:

One of a handful of structures with any architectural style per se within the three (3) block commercial part of Hyattsville along U.S. 1 (Baltimore Avenue), this building relieves some of the dowdiness and irregularity of the streetscape. It may be significant locally.

SUBURBAN TRUST BANK BUILDING
Page 2

to the community as a banking institution as well, given the genesis of its predecessor, Prince George's Bank, in the community in 1915.

Prepared by Ms. Rita M. Suffness, Architectural Historian with the Maryland State Highway Administration (659-1183).

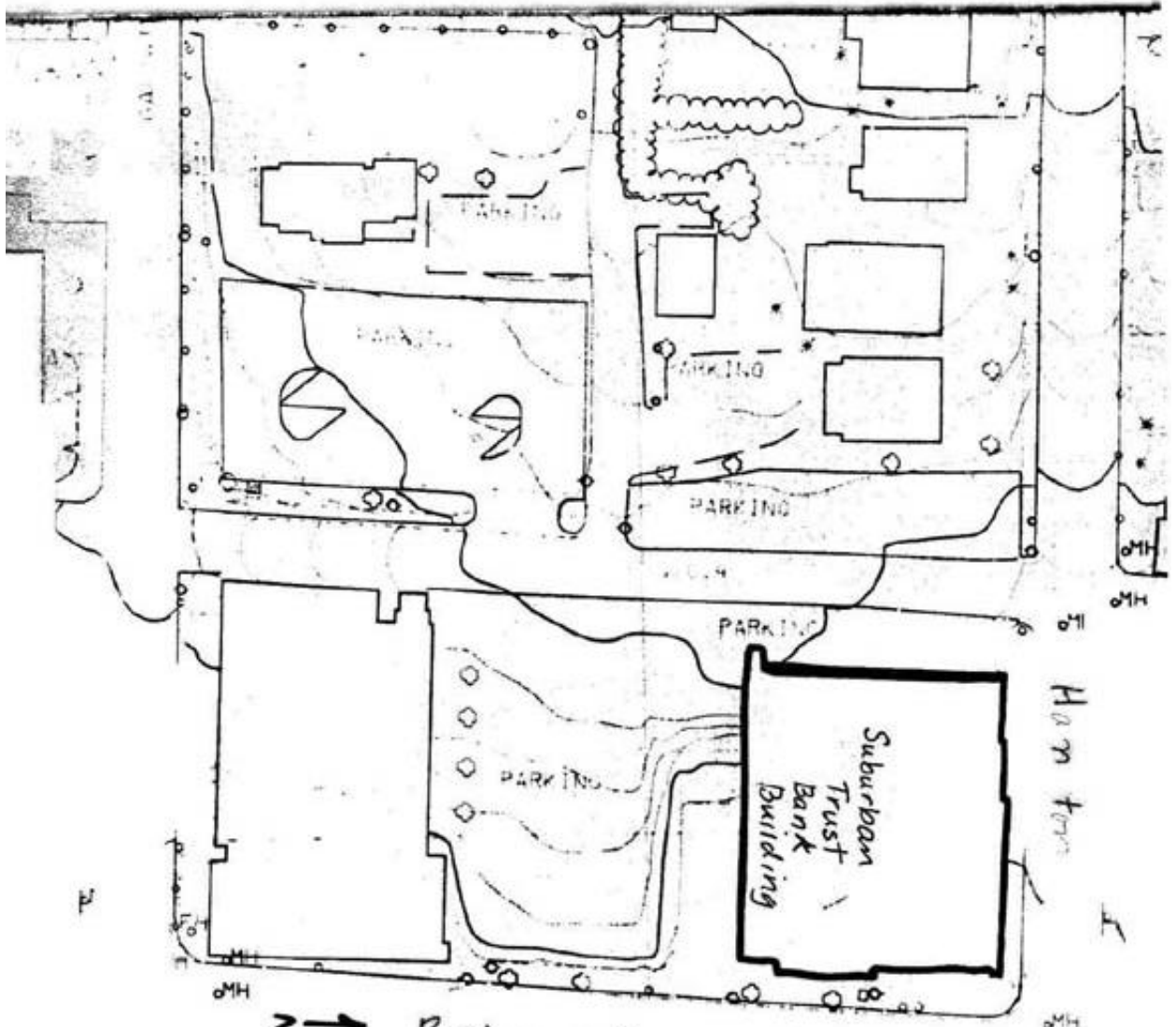

2 → Biltmore Avenue 6th Route

